

RKBC Reeved Chain Air Balancer Series



Air Balancers are used in applications where a "float" condition is beneficial. Float allows for the hands-free final positioning of an object. The up/down speed of a air balancer is quicker when compared to a hoist and allows for a "feathering" operation when locating the load. The pendant controls are ergonomically designed incorporating color coded thumb levers. Reeving a air balancer increases the mechanical advantage of the product.

Additionally the reeve and pulley offers a second suspension point which gives greater stability to the load. Reeved air balancers come standard with a 1 ton spring lock bail hook. Chain air balancers are primarily designed for weights exceeding 250 lbs or for high cycle applications.

RKBC CHAIN SERIES SPARE PARTS			
2	1	BPA2066	REEVED HOOK CABLE PULLEY
1	1	BPD1036	CHAIN
DET	QTY	PART #	DESCRIPTION

Formula for Air Balancer sizing:

Example: plant air 80 psi, 350 air balancer, 80% load capability
 $(0.80 \text{ air supply} \times 350 \text{ lbs.} = 280 \times .80 = 224 \text{ lbs. load capability})$.

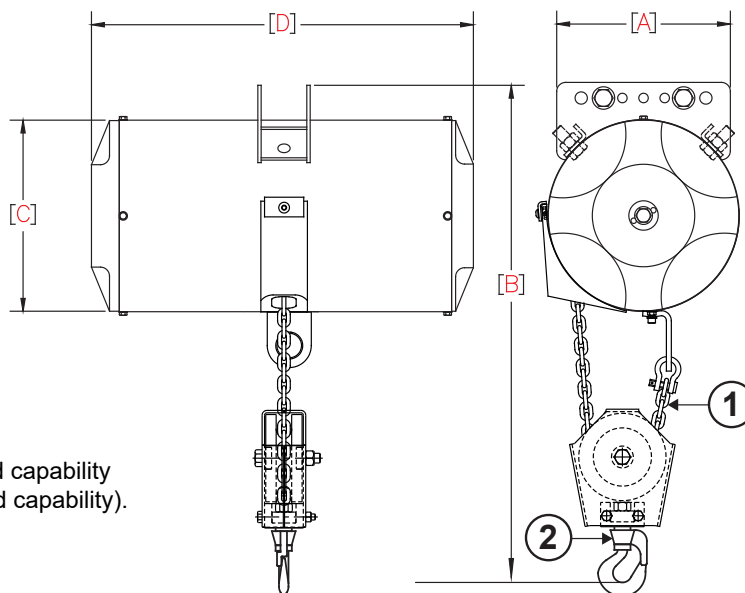

Rated at 100 PSI

MODEL #	RATED CAPACITY lbs [kg]	TRAVEL in [mm]	(A) in [mm]	(B) (min.) in [mm]	(C) in [mm]	(D) in [mm]	UNIT WEIGHT lbs [kg]
RKBC400-055	400 [181]	55 [1,397]	8 1/2 [216]	24 1/4 [615]	6 1/2 [165]	15 1/2 [394]	99.0 [44.91]
RKBC450-033	450 [204]	33 [838]	10 3/4 [273]	22 1/4 [565]	10 3/4 [273]	16 1/2 [419]	66.6 [30.21]
RKBC700-033	700 [318]	33 [838]	8 3/4 [222]	24 1/4 [615]	8 3/4 [222]	16 3/4 [426]	81.6 [37.01]
RKBC1000-040	1,000 [454]	40 [1,016]	9 3/4 [248]	24 1/4 [615]	10 3/4 [27]	16 1/2 [419]	118.6 [53.80]
RKBC1400-026	1,400 [635]	27 [686]	9 3/4 [248]	24 1/4 [615]	10 3/4 [27]	21 13/16 [554]	98.6 [44.72]

**** Knight recommends the use of a high performance, extreme pressure, anti-wear food grade penetrating oil that penetrates and lubricates cable and all types of moving parts. (Lubri-Link-Green®)**

