

KEAA2500 Single Bridge Extension Arm

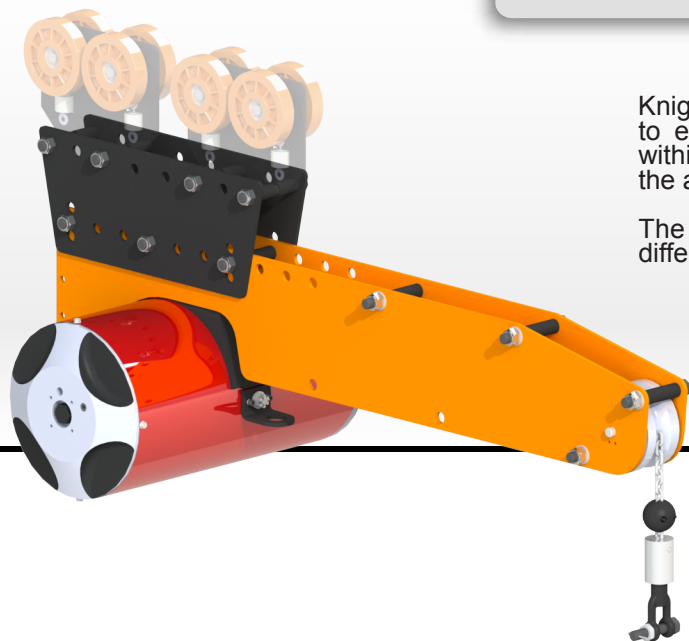

Knight Global's Single Bridge Extension Arms enable the operator to extend beyond the working limits of an overhead rail system within a workstation. A Knight Pneumatic/Air Balancer mounts to the arm which will lift and lower the load.

The KEAA2500 Series Extension Arm can be adjusted to (4) different positions.

Rated Capacity		Travel
Model	100 P.S.I.	Inches
KEAA2500-200	200 lbs.	110
KEAA2500-350	350 lbs.	67
KEAA2500-500	500 lbs.	80
KEAA2500-700	700 lbs.	50

Formula for Air Balancer sizing:

Example: plant air 80 psi, 350 air balancer, 80% load capability
 $(0.80 \text{ air supply} \times 350 \text{ lbs.} = 280 \times .80 = 224 \text{ lbs. load capability})$.

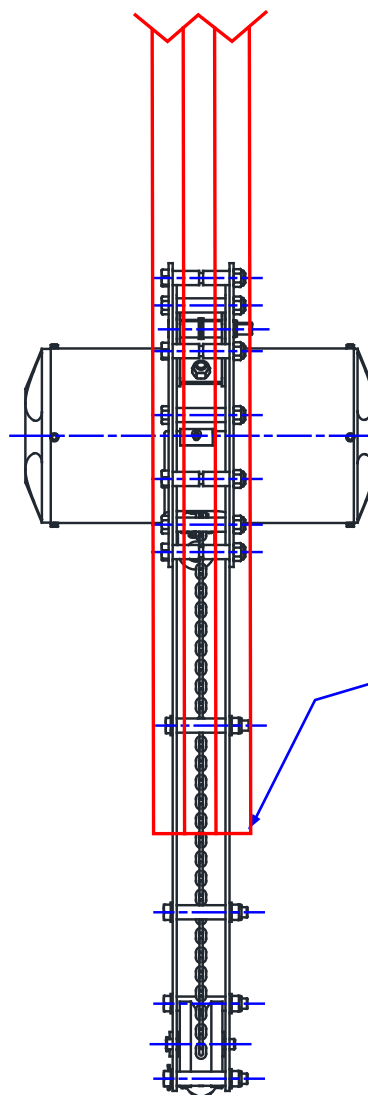

KEAA2500 Features

- CE Compliant on Request.
- Chain Configuration.
- Various Control Configurations.
- Expands the working area of a typical balancer
- Angular Adjustment in 10° increments.
(10° UP / 10° DOWN)
- Horizontal Adjustments: Up to 6.8 in. [172mm].
(2.3 in. Increments)
- Requires Non-Lubricated Clean/Dry Air.

**** Standard KEAA2500 Series do not come CE certified, but can be made CE compliant upon request.**

KEAA2500 Single Bridge Extension Arm

Arm Accessories

Trolleys
(Custom Trolleys Available)

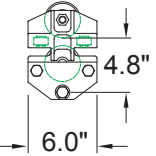
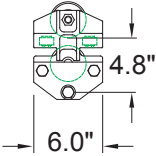
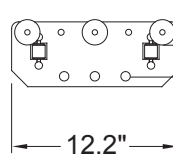
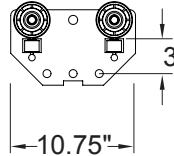
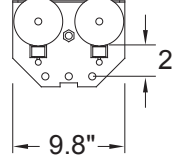
KEAA1050 for 3.25 or 3.33	KEAA1051 for 2.66" Flange 4.00" S-Beam	MRTA4442 Knight 4110 Series Rail	MRTA6106 Knight 6110 Series Rail	MRTA7706 Knight 7510 Series Rail
				
4.8" 6.0"	4.8" 6.0"	2.3" 12.2"	3.1" 10.75"	2.9" 9.8"

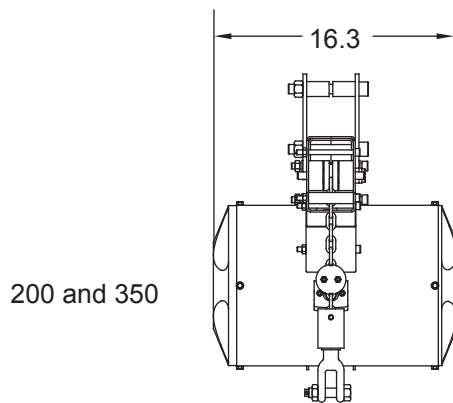

200 and 350

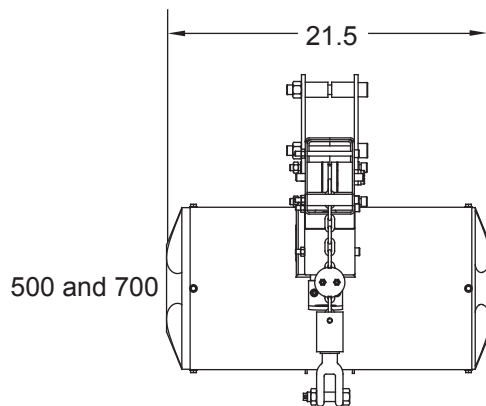

500 and 700

EXAMPLE:
ORDER # : KEAA2500_500

Arm Desc.	Capacity
KEAA2500	XXX
	200
	350
	500
	700

